

DUAL PORT D-SUB P.C.B. DIP

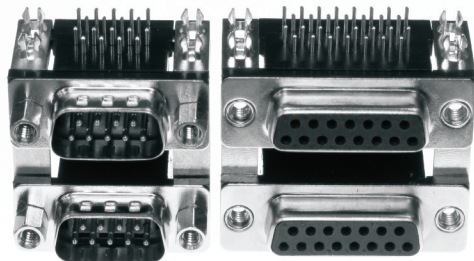

Material & finish

SHELL:

Steel
Nickel plated steel

PIN CONTACT:

Phosphor bronze
Gold plated

INSULATOR:

PBT & Glass-fibre
reinforced UL 94-V0

CURRENT RATING:

5 Amp

DIELECTRIC STRENGTH:

1000V for one minute

INSULATOR RESISTANCE:

1000M Ω Min.(at 500V DC)

TEMPERATURE:

-55°C to +105°C

D-SUB

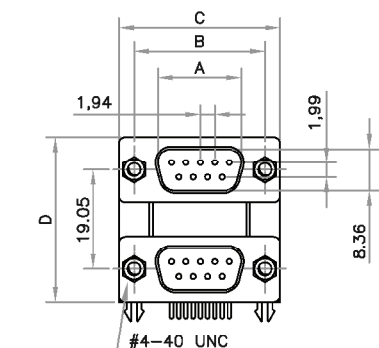

MALE

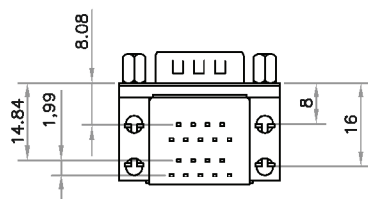

MALE

Size	A	B	C
09	16.33	24.99	30.81
15	24.66	33.32	39.14
25	38.38	47.04	53.04

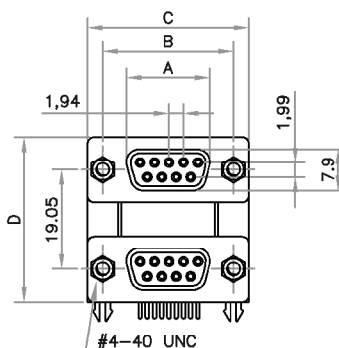

FEMALE

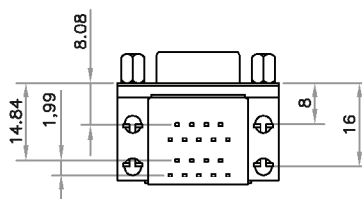

FEMALE

Size	A	B	C
09	16.92	24.99	30.81
15	25.25	33.32	39.14
25	38.96	47.04	53.04

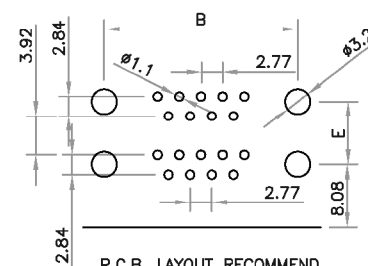
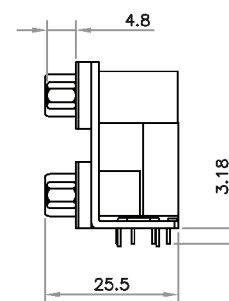

P.C.B. LAYOUT RECOMMEND

PITCH

D	E
22.86	35.40
19.05	31.50
15.88	28.33

ORDERING INFORMATION

DRD - XX YY X X X X X 0 X X X 0 0

TYPE

DRD: D-SUB DUAL PORT
R/A TYPE

XX: No. OF UPPER CONTACTS
YY: No. OF LOWER CONTACTS

INSULATOR COLOR
B: BLUE
K: BLACK

CONTACT PLATING
A: G/F
E: 15u"
F: 30u"

SHELL PLTING
A: NICKEL
B: TIN

BRACKET PITCH
A: 15.875mm
B: 19.05mm
C: 22.86mm

INSULATOR LENGTH
B: 5.08mm
D: 8.08mm
E: 8.89mm
H: 14.84mm

SPECIAL FUNCTION
A: RIVET (ϕ 3.2)
B: RIVET (#4-40)

SPECIAL FUNCTION
A: SCREW 4.8mm HEX
D: SCREW 5.8mm HEX
G: SCREW 6.1mm HEX (M3)
H: SCREW 6.1mm HEX (M2.6)