

# D-SUB P.C.B. LOW PROFILE DIP RIGHT ANGLE



## Material & finish

### SHELL:

Steel  
Tin plated steel

### PIN CONTACT:

Phosphor bronze  
Gold plated

### INSULATOR:

Nylon 6T, Fiber reinforced  
UL 94-V0, color black

### CURRENT RATING:

3 Amp

### DIELECTRIC STRENGTH:

AC 500V for one minute

### INSULATOR RESISTANCE:

1000M $\Omega$  Min.(at 500V DC)

### TEMPERATURE:

-55°C to +105°C

D-SUB

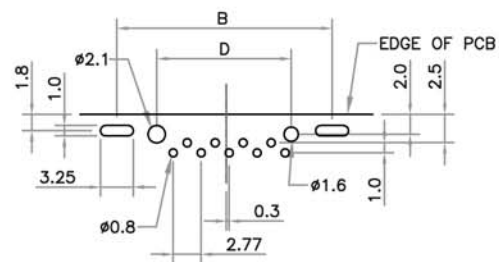
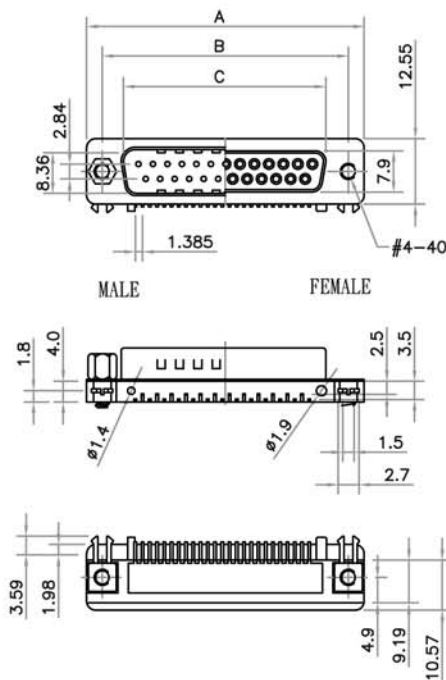

MALE P. C. B. LAYOUT

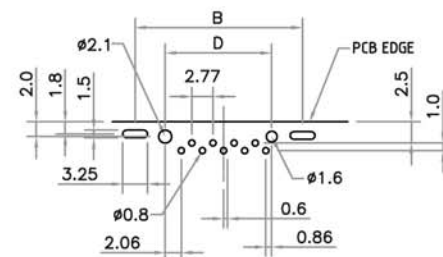

FEMALE P. C. B. LAYOUT

### MALE

	A	B	C	D	E
09	30.81	24.99	16.92	15.90	11.08
25	53.04	47.04	38.96	38.06	33.24

### FEMALE

	A	B	C	D	E
09	30.81	24.99	16.33	14.00	11.08
25	53.04	47.04	38.38	39.54	33.24

## ORDERING INFORMATION

DL1 - XX X X X X A X X 0 0

### TYPE

DL1: LOW PROFILE  
D-SUB TWO ROWS  
DL2: LOW PROFILE  
D-SUB ONE ROW

### No. OF CONTACTS

09  
25

### CONTACT TYPE

P: PLUG  
S: SOCKET

### INSULATOR COLOR

B: BLUE  
K: BLACK

### CONTACT PLATING

A: GOLD FLASH  
E: 15u"  
F: 30u"

### GROUND TAB

A: RIVET #4-40 Z SHAPE

### SHELL PLATING

A: NICKEL  
B: TIN

### SPECIAL FUNCTION

A: RIVET (#4-40)  
B: RIVET  
C: SCREW

### SPECIAL FUNCTION

A: 4.8mm HEX SCREW LOCK  
B: 5.8mm HEX SCREW LOCK  
C: W/H 4.8mm HEX

RoHS COMPLIANT

REV	DATE	DESCRIPTION
H	10/23/'17	#065 Update, 錫殼→鍍殼
I	08/28/'20	六角螺絲改用無鉛料

Apply: Arisa

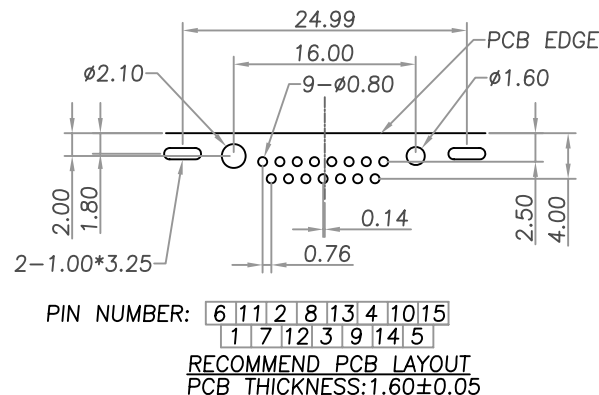
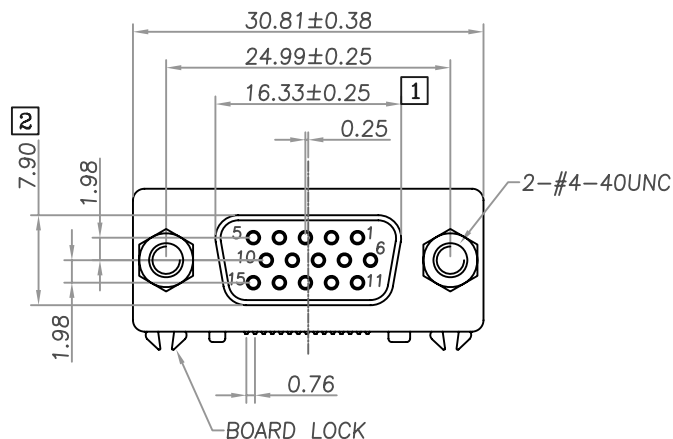

#### Material & Finish

##### SHELL:

Steel, Nickel Plated

##### PIN CONTACT:

Phosphor Bronze  
Gold Flash Plated

##### INSULATOR:

PBT & Glass-fibre reinforced  
UL-94-V0 Blue or Black

##### BOARD LOCK:

Brass, Tin Plated

##### HEX SCREW:

△ Copper Alloy(Pb-free), Nickel Plated

##### CURRENT RATING:

5 Amp

##### VOLATAGE RATING:

300VDC

##### CONTACT RESISTANCE:

13mΩ

##### DIELECTRIC STRENGTH:

500VAC for one minute

##### INSULATOR RESISTANCE:

1000MΩ Min. (at 500VDC)

##### TEMPERATURE:

-55°C to +105°C

##### SCREW TORSIONAL:

Lock Force 2.5kgf.com MIN  
OUT Force 1.0kgf.com MIN

##### PACKING:

15pcs/Tube  
42Tube/Small Carton  
4Small Carton/Big Carton  
(Total 2520pcs/Big Carton)

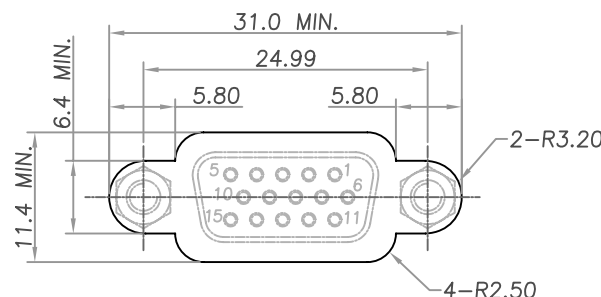
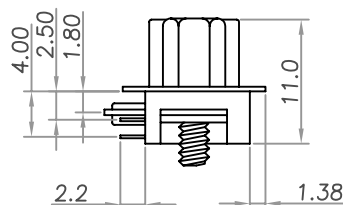
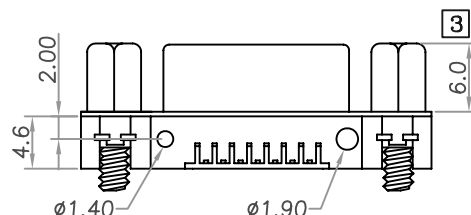

RECOMMEND PANEL CUTOUT

INSULATOR COLOR  
B:BLUE  
K:BLACK

SHELL PLATING

A:NICKEL

B:TIN (PHASE OUT)

MOUNTING TYPE

D:APPOSE 5.0 HEX SCREW

G:LOCK 6.0 HEX SCREW

FU-YAO TECHNOLOGY CO., LTD.

復堯科技股份有限公司

MODEL NAME:

D-SUB HIGH DENSITY LOW PROFILE  
PCB R/A TWO ROWS TYPE FEMALE  
15PIN, LOCK 6.0 HEX SCREW

MARK EXPLAIN:

△:Revision Change

①:Important Dimension

①:Note

TOLERANCE:

0.000:

0.00 ±0.15

0.0 ±0.25

0. ±0.40

ANGLE: ±3.0°

UNIT: mm

PART NO. DL1-HSBAAAGAA0

APPROVED BY: ALBERTA

CHECKED BY: EDEA

DRAW BY: ALAN

FILE NO.FIG00994-4

SCALE: 1/1

DATE: 1010412