

D-SUB P.C.B. DIP RIGHT ANGLE

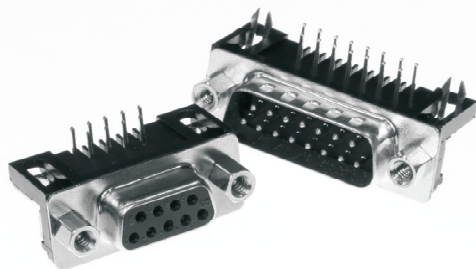

Material & finish

SHELL:
Steel
Nickel plated steel

PIN CONTACT:
Phosphor bronze
Gold plated

INSULATOR:
PBT & Glass-fibre
reinforced UL 94-V0

CURRENT RATING:
5 Amp

DIELECTRIC STRENGTH:
1000V for one minute

INSULATOR RESISTANCE:
1000M Ω Min.(at 500V DC)

TEMPERATURE:
-55°C to +105°C

D-SUB

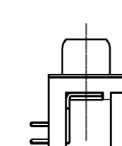
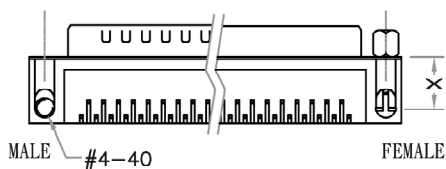
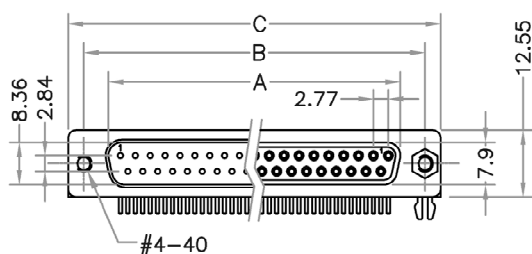

RIVET+L SHAPE

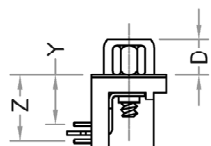

HEX SCREW LOCK+BOARDLOCK

MALE

	A	B	C	D
09	16.92	24.99	30.81	5.9
15	25.25	33.32	39.14	5.9
25	38.96	47.04	53.04	5.9
37	55.42	63.50	69.32	5.9

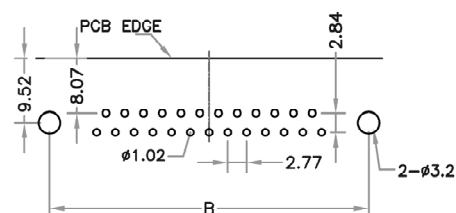

P. C. B. LAYOUT

STYLE

	X	Y	Z
DR1	9.52	8.07	10.91
DR2	11.62	10.20	13.04
DR3	16.00	14.84	17.68

FEMALE

	A	B	C	D
09	16.33	24.99	30.81	5.9
15	24.66	33.32	39.14	5.9
25	38.38	47.04	53.04	5.9
37	54.84	63.50	69.32	5.9

ORDERING INFORMATION

DR1 - XX X X X X X X X X X 0 0

TYPE

DR1: D-SUB R/A
DR2: D-SUB R/A DIP
MACHINED PIN

No. OF CONTACTS

09
15
25
37

CONTACT TYPE

P: PLUG
S: SOCKET

INSULATOR COLOR

B: BLUE
K: BLACK

CONTACT PLATING

A: GOLD FLASH
E: 15u"
F: 30u"

SHELL PLATING

A: NICKEL
B: TIN

INSULATOR LENGTH

A: 5.0mm (5.00)
B: 7.2mm (8.08)
C: 9.4mm (10.2)
D: 13.84mm (14.84)

GROUND TAB

A: L SHAPE
B: Z SHAPE

SPECIAL FUNCTION

A: 4.8mm HEX SCREW LOCK
D: 5.8mm HEX SCREW LOCK
F: 6.1mm HEX SCREW LOCK

SPECIAL FUNCTION

0: SCRW LOCK
A: RIVET (#4-40)

SPECIAL FUNCTION

A: W/H 4.8mm HEX
SCREW