

# HIGH DENSITY DB SOLDER



## Material & finish

**SHELL:**  
Steel  
Nickel plated steel

**PIN CONTACT:**  
Phosphor bronze  
Gold plated

**INSULATOR:**  
PBT & Glass-fibre  
reinforced UL 94-V0

**CURRENT RATING:**  
5 Amp

**DIELECTRIC STRENGTH:**  
1000V for one minute

**INSULATOR RESISTANCE:**  
1000MΩ Min.(at 500V DC)

**TEMPERATURE:**  
-55°C to +105°C

D-SUB

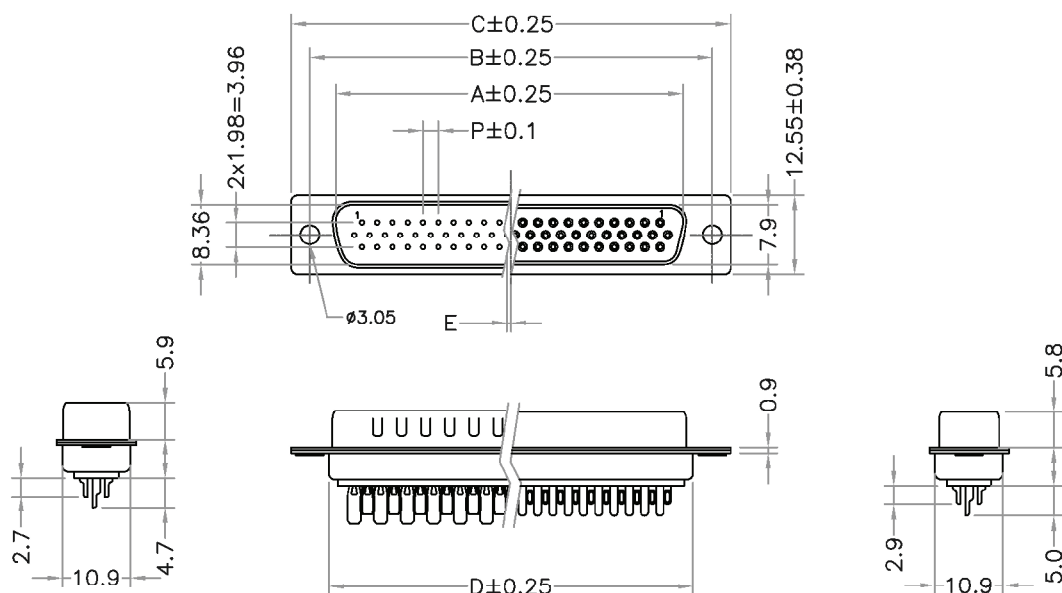

MALE

	A	B	C	D	E	P
15	16.92	24.99	30.81	19.28	0.25	2.29
26	25.25	33.32	39.14	27.65	0.25	2.29
44	38.96	47.04	53.04	41.30	0.25	2.29
62	55.42	63.50	69.32	57.44	0.31	2.41

FEMALE

	A	B	C	D	E	P
15	16.33	24.99	30.81	19.28	0.25	2.29
26	24.66	33.32	39.30	27.65	0.25	2.29
44	38.38	47.04	53.04	41.30	0.25	2.29
62	54.84	63.50	69.32	57.44	0.31	2.41

## ORDERING INFORMATION

HD - XX X X X X X X 0 0

**TYPE**  
HD: HIGH DENSITY  
D-SUB SOLDER

**No. OF CONTACTS**

15  
26  
44  
62

**CONTACT TYPE**  
P: PLUG (CUP)  
S: SOCKET (CUP)  
M: PLUG

**INSULATOR COLOR**  
B: BLUE  
K: BLACK

**SHELL PLATING**  
D: TIN  
C: NICKEL FRONT &  
TIN BACK

**CONTACT PLATING**  
A: GOLD FLASH  
E: 15u"  
F: 30u"

**SPECIAL FUNCTION**  
A: BACK RIVET 4.0mm HEX  
F: BACK RIVET 5.8mm HEX

**SPECIAL FUNCTION**  
B: FRONT RIVET 5.8mm HEX