

RoHS COMPLIANT

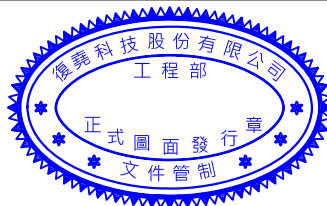

REV	DATE	DESCRIPTION
A	01/28/'13	From RR6-36SKAAGU4N00 / Fig00967-7

Material & Finish

SHELL:

Steel
Zinc plated, Tin plated
or Nickel plated steel

PIN CONTACT:

Phosphor Bronze
Gold plated

INSULATOR:

PBT & Glass-fibre reinforced
UL-94-V0

CURRENT RATING:

5 Amp

DIELECTRIC STRENGTH:

1000V for one minute

INSULATOR RESISTANCE:

1000M Ω Min. (at 500V DC)

TEMPERATURE:

-55°C to +105°C

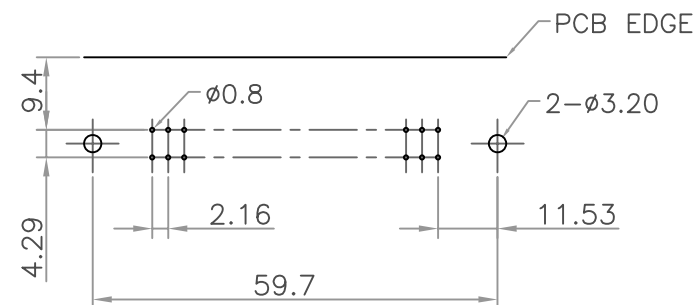
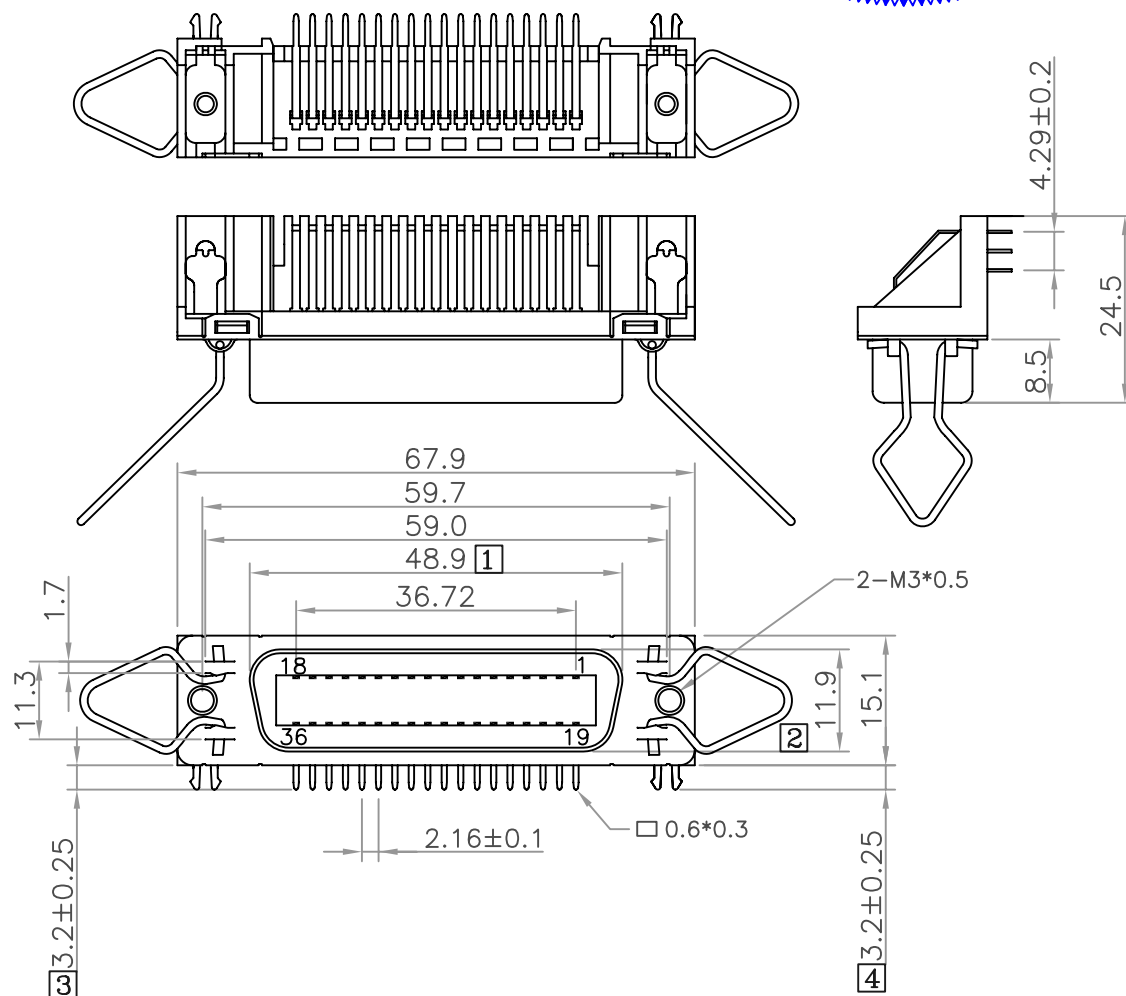

P.C.B. LAYOUT

FU-YAO TECHNOLOGY CO., LTD.

復堯科技股份有限公司

MODEL NAME:

CENTRONIC P.C.B. RIGHT ANGLE TYPE
FEMALE 3.2mm RIVET M3 3.2mm Z
SHAPE WITH SPRING LATCH

MARK EXPLAIN:

Δ :Revision Change
[1]:Important Dimension
①:Note

TOLERANCE:

0.000:
0.00 : \pm 0.20
0.0 : \pm 0.30
0. : \pm 0.40
ANGLE: \pm 3.0°

UNIT: mm

PART NO. RR6-36SKAAGU9N00

APPROVED BY:

CHECKED BY:

DRAW BY: ALAN

FILE NO. FIG00967-11

SCALE: FREE

DATE: 1020128

RoHS COMPLIANT

REV	DATE	DESCRIPTION
A	11/14/"11	
B	12/05/"11	(Official Drawing)
C	08/31/"12	Panel Cut & Screw Torsional

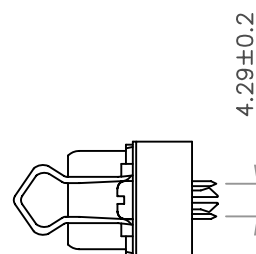
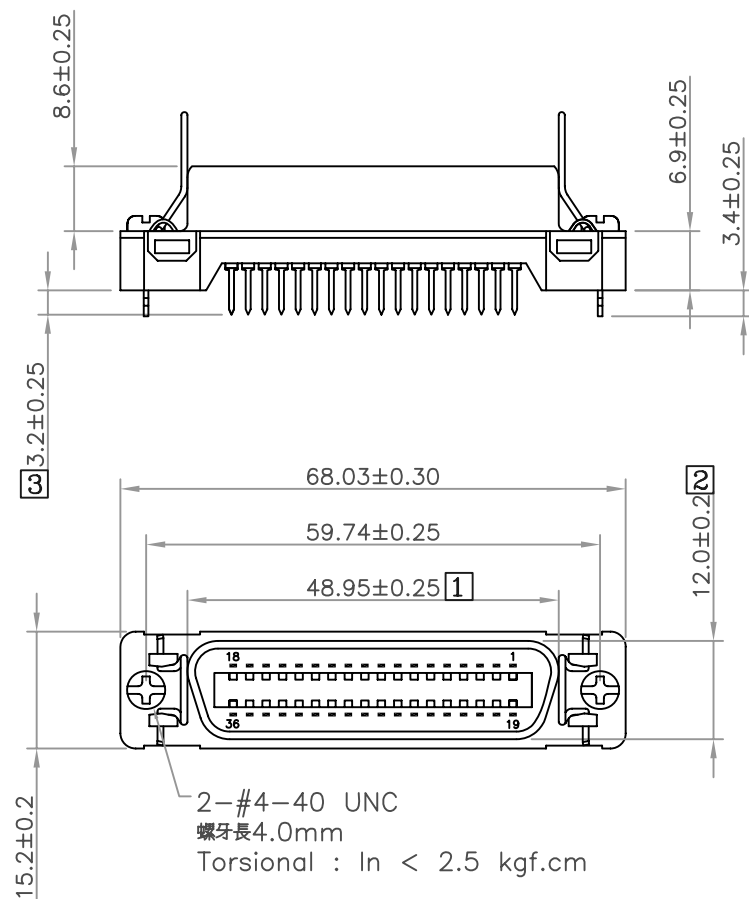

Material & Finish

SHELL:

Nickel plated Steel

PIN CONTACT:

Phosphor Bronze, Glod plated

INSULATOR:

PBT & Glass-fibre reinforced
UL-94-V0, Black

NUMBER OF CONTACT:

36

CURRENT RATING:

5 Amp

DIELECTRIC STRENGTH:

1000V for one minute

INSULATOR RESISTANCE:

1000MΩ Min. (at 500V DC)

TEMPERATURE:

-55°C to +105°C

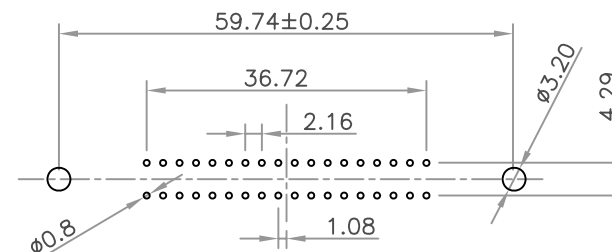
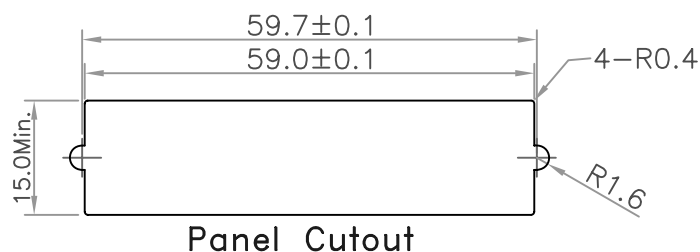

FU-YAO TECHNOLOGY CO., LTD.

復堯科技股份有限公司

MODEL NAME:

CENTRONIC P.C.B. S/T TYPE FEMALE
LOCK SCREW & BOARD LOCK & SPRING
LATCH

MARK EXPLAIN:

△:Revision Change
①:Important Dimension
①:Note

TOLERANCE:

0.000:
0.00 : ±0.20
0.0 : ±0.30
0. : ±0.40
ANGLE: ±3.0°

UNIT: mm

PART NO. RS6-36SKAAB4L00

APPROVED BY:

CHECKED BY:

DRAW BY: LEE

FILE NO.FIG00525-8

SCALE: FREE

DATE : 1001109