

PLCC SOCKET SERIES

FU-YAO TECHNOLOGY CO., LTD.

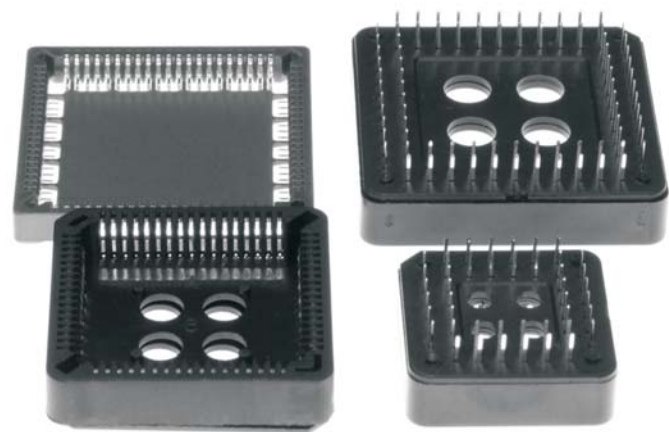

Material & finish

PIN CONTACT:

Brass
Gold plated

INSULATOR:

PBT & Glass-fibre
reinforced UL 94-V0

OPERATING TEMPERATURE:

-40°C to +105°C

CURRENT RATING:

3 Amp

CONTACT RESISTANCE:

20 millohms MAX.

INSULATOR RESISTANCE:

5000 Megohms Min.

VOLTAGE RATING:

250VAC. R.M.S.

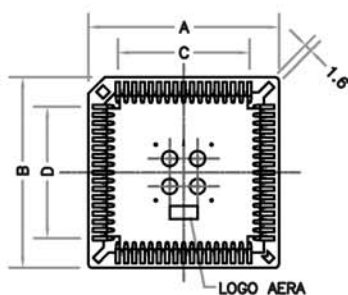

P. C. B. LAYOUT

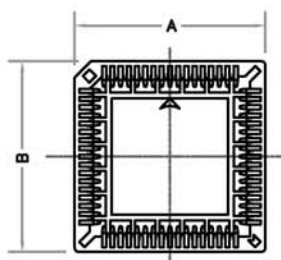
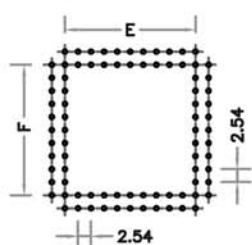

P. C. B. LAYOUT

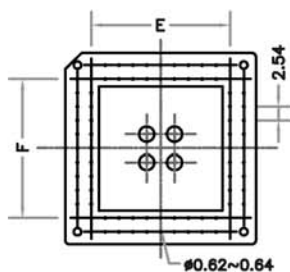
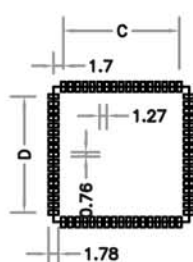

DIP TYPE

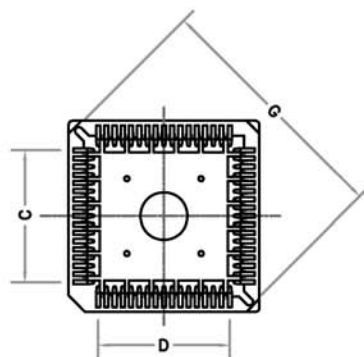
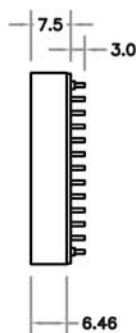

SMT TYPE

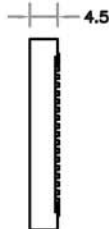

DIMENSION(DIP)

	A±0.15	B±0.15	C±0.15	D±0.15	E±0.15	F±0.15
20	15.50	15.50	5.08	5.08	5.08	5.08
28	18.04	18.04	7.62	7.62	7.62	7.62
32	18.04	20.54	7.62	10.16	7.62	10.16
44	23.48	23.48	12.70	12.70	12.70	12.70
52	25.88	25.88	15.24	15.24	15.24	15.24
68	31.04	31.04	20.32	20.32	20.32	20.32
84	36.04	36.04	25.40	25.40	25.40	25.40

DIMENSION(SMT)

	A±0.2	B±0.2	C±0.2	D±0.2	G±0.2
20	15.50	15.50	5.08	5.08	16.70
28	18.04	18.04	7.62	7.62	20.30
32	18.20	20.74	7.62	10.16	22.76
44	23.28	23.28	12.70	12.70	28.05
52	25.88	25.88	15.24	15.24	31.10
68	31.04	31.04	20.32	20.32	38.30
84	36.04	36.04	25.40	25.40	45.50

ORDERING INFORMATION

PLCC - XX X X T X 0 0

TYPE
PLCC: PLCC SOCKET

No. OF CONTACTS
20~84

LAYOUT TYPE
S: DIP S/T DIP
M: SMT TYPE

PACKAGE TYPE
A: TUBE (STANDARD)
B: TUBE WITH REEL

CONTACT PLATING
T: TIN PLATED

INSULATOR COLOR
K: BLACK
M: BROWN